

Single direction synchronous geared motors

→ 0.5 Nm 3.5 Watts

- Mechanical strength : 0.5 Nm
- Constant speed, dependent on supply frequency
- Wide range of speeds available
- Direction of rotation controlled by long-life mechanical anti-return device
- Permanent magnet rotor



Specifications

	3.5 Watts	3.5 Watts	3.5 Watts	3.5 Watts
Type	82 334 5	82 334 5	82 334 5	82 334 5
Direction of rotation	Anti-clockwise	Clockwise	Anti-clockwise	Clockwise
Voltages/Frequencies	230 V 50 Hz	230 V 50 Hz	240 V 50 Hz	240 V 50 Hz
Output speed	Ratios (i)			
60 rpm	10	82 334 734	82 334 726	82 334 811
50 rpm	12	●	●	●
30 rpm	20	82 334 728	82 334 736	82 334 805
20 rpm	30	82 334 730	82 334 738	82 334 807
15 rpm	40	82 334 731	82 334 739	82 334 808
12.5 rpm	48	●	●	●
12 rpm	50	82 334 733	82 334 741	82 334 810
10 rpm	60	82 334 756	82 334 764	82 334 772
7.5 rpm	80	82 334 758	82 334 766	82 334 774
6 rpm	100	82 334 759	82 334 767	82 334 775
5 rpm	120	82 334 760	82 334 768	82 334 776
4 rpm	150	82 334 769	82 334 761	82 334 785
3 rpm	200	●	●	●
2.5 rpm	240	●	●	●
2 rpm	300	82 334 748	82 334 742	82 334 796
1 rpm	600	82 334 744	82 334 751	82 334 792
0.80 rpm	750	●	●	●
0.5 rpm	1200	●	●	●
0.33 rpm	1800	●	●	82 334 794
0.25 rpm	2400	●	●	●
0.20 rpm	3000	●	●	●
0.10 rpm	6000	●	●	●
5.00 rph	7200	●	●	●
4.00 rph	9000	●	●	●
3.00 rph	12000	●	●	●
2.50 rph	14400	●	●	●
1.00 rph	36000	●	●	●
0.50 rph	72000	●	●	●
1/12 rph	432000	●	●	●
1/24 rph	864000	●	●	●
General characteristics				
Motor	82 340 0	82 340 0	82 340 0	82 340 0
Gearbox	81 021 0	81 021 0	81 021 0	81 021 0
Maximum permitted torque from gearmotor under continuous conditions for 1 millions turns of the gearmotor (Nm)	0.5	0.5	0.5	0.5
Axial load static (daN)	1	1	1	1
Radial load static (daN)	8	8	8	8
Absorbed power (W)	3	3	3	3
Motor output (W)	0.16	0.16	0.16	0.16
Maximum temperature rise (°C)	55	55	55	55
Ambient temperature (°C)	-5 → +60	-5 → +60	-5 → +60	-5 → +60
Weight (g)	160	160	160	160
Wires length mm (approximately)	250	250	250	250
Protection rating	IP40	IP40	IP40	IP40

To order, see page 13

Product adaptations

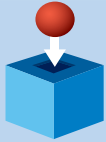

- Special supply voltages
- Special cable lengths
- Special connectors
- Special output shafts
- Special gearbox ratios
- Special gear wheel material
- Special output bearings

Curves

Graph of torque versus speed 82 334 5

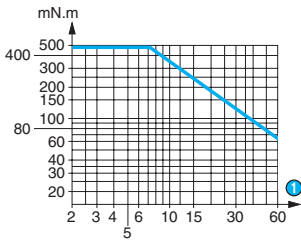

① RPM

Dimensions

82 334 5

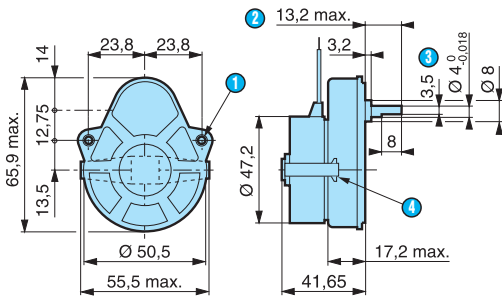

- ① 2 fixing holes $\text{Ø } 3.2$
- ② (pushed-in shaft)
- ③ 3.5 across flat
- ④ Fixing clip

Options

Shaft 79 200 967

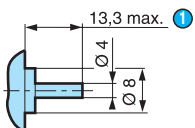

- ① (pushed-in shaft ←)

Shaft 79 200 779

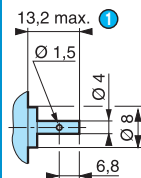

- ① (pushed-in shaft ←)

Shaft 70 999 421 SP1295-10

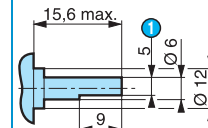

- ① Across flat

Other information

The speed of a motor powered by a 60 Hz supply is 20 % higher than that of a motor powered by a 50 Hz supply.