

## Diffuse sensors with background suppression

### OHDK 10P5101/S35A

#### dimension drawing

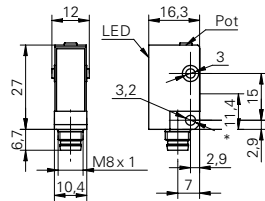

\* emitter axis

#### general data

type	background suppression
light source	pulsed red laser diode
sensing distance $T_w$	22 ... 130 mm
sensing range $T_b$ (at $T_w$ max.)	3 ... 130 mm
sensing range $T_b$ (at $T_w$ min.)	3 ... 22 mm
repeat accuracy	< 0,2 mm at laser focus
power on indication	LED green
light indicator	LED yellow
sensing distance adjustment	mechanical, 5 turn
laser class	2
distance to focus	40 mm
wave length	650 nm
suppression of reciprocal influence	yes

#### electrical data

response time / release time	< 0,25 ms
voltage supply range +Vs	11 ... 30 VDC
current consumption max.	30 mA
current consumption typ.	25 mA
voltage drop $V_d$	< 1,8 VDC
output function	light / dark operate
output circuit	PNP
output current	< 100 mA
short circuit protection	yes
reverse polarity protection	yes, supply only

#### mechanical data

width / diameter	10,4 mm
height / length	27 mm
depth	16,3 mm
type	rectangular
housing material	plastic (ASA)
front (optics)	PMMA
connection types	connector M8 4 pin

#### photo



#### connection diagram

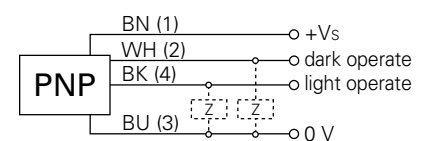

#### laser warning

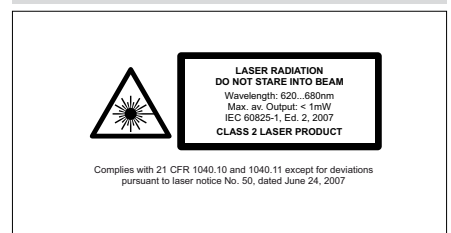

## Diffuse sensors with background suppression

## OHDK 10P5101/S35A

### ambient conditions

operating temperature	-10 ... +50 °C
protection class	IP 67